

BILLION[®]

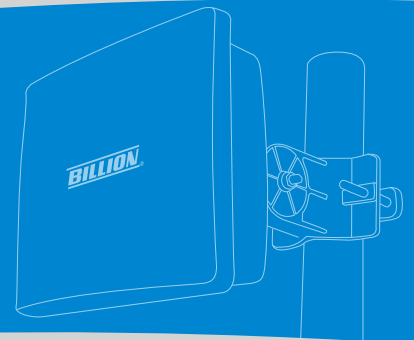

Communication Series Product Portfolios



Billion Communication Series Product Portfolios



4G/LTE Broadband Router Series

- BEC 6200 Series
- BEC 6300VNL
- BEC 6300NL
- BEC 6800RUL



3G/4G LTE Router ADSL2+ Router Series

- BiPAC 7800NX
- BiPAC 7800NXL
- BiPAC 7800DX
- BiPAC 7800DXL
- BiPAC 7600NX
- BiPAC 7600NXL
- BiPAC 7600X
- BiPAC 7800X



3G/4G LTE Embedded ADSL2+ Router Series

- BiPAC 7800GZ
- BiPAC 7820NZ



3G/4G LTE Broadband Router Series

- BiPAC 6300NX
- BiPAC 6300NXL



Point-to-Point Fibre Router Series

- BiPAC 9800VNX-PD



Switch Series

- BiPAC FGS-2024-4S
- BiPAC GS2008-2S-HP
- BiPAC GS2024-6S-HP
- BiPAC GS2048-4S-HP
- BiPAC SGS2003-HP



VDSL2 Series

- BiPAC 8200M
- BiPAC 8300N(X)L R3
- BiPAC 8400N(X)L
- BiPAC 8800AXL
- BiPAC 8800NL



VoIP ADSL2+ Router Series

- BiPAC 7800VDOX
- BiPAC 7800VDPX
- BiPAC 8900TAOX



SHDSL Router Series

- BiPAC 8501 R3
- BiPAC 8521 R3



Wireless AP/Router Series

- BiPAC 3100SN
- BiPAC 7800N
- BiPAC 7800NL
- BiPAC 7700N R2
- BiPAC 7300N RE
- BiPAC 7300NX
- BiPAC 7300W R2
- BiPAC 5400W R2
- BiPAC 5200W
- BiPAC 5400N R2
- BiPAC 3100SN



Wireless Adapter

- BiPAC 3011N
- BiPAC 3010A



Powerline Series

- BiPAC 2098
- BiPAC 2093 R2
- BiPAC 2094 R2
- BiPAC 2076
- BiPAC 2075
- BiPAC 2073N
- BiPAC 2073 R2
- BiPAC 2074 R2

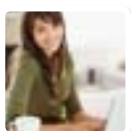

ADSL2+ Modem/Router Series

- BiPAC 5200 RC
- BiPAC 7300 RA
- BiPAC 7800

Fixed Wireless Broadband by 4G LTE



4G LTE represents the latest generation of wireless broadband technology providing improved spectrum efficiency, lowering cost, greater capacity, coverage and higher data rate comparable with wired service offerings. 4G LTE allows service providers to support new applications, develop new business models and opportunities in new vertical markets such as Public Safety and M2M. In addition to faster speeds and new service possibilities, 4G LTE has significant economic and societal implications in the ability to provide broadband (wirelessly) to markets and areas that are currently un-served or underserved.

Key Features:

- Broad range of devices: fixed routers, VoIP gateways, outdoor routers and industrial solutions
- Advanced SX antenna technology for increased coverage, signal reception and efficiency
- Supporting North America and global LTE bands
- Feature rich and high performance platforms enabling advanced functionality such as dual-APN
- Site installation aides and tools to support rapid deployment and remote management



LTE is the fastest developing mobile system technology and is now more mainstream than ever. Since the launch of the first commercial 4G LTE networks in late 2009, Billion has seen deployments accelerate across the globe. We focus on building the best-in-class portfolio of solutions allowing our customers to take full advantage of all the benefits of 4G LTE.

Key Advantages:

- Superior RF and antenna engineering for maximum LTE performance
- Hardware and software specifically designed for carrier operations
- Mass deployments and remote managements experience in US market
- Core 3G/4G/LTE CPE technologies:
 - Cellular and RF integration
 - Dual APN
 - LTE and LAN QoS
 - Dedicated bearer
 - Signal enhancement
 - Home control & monitoring
 - Industrial M2M cellular
 - CPE device management system & monitoring software

4G/LTE Broadband Router Series



BEC 6200 Series 4G/LTE Routers

- Supports frequency bands:
 - √ LTE: B2/B4/B5/B12/B13/B17/B25
- Peak 100Mbps/50Mbps download/upload speed
- Dual APN with port mapping
- SIM card slot (no USB dongle required)
- Two detachable 4G MIMO antennas with SX7 antenna technology
- Dual WAN interfaces: 4G and EWAN
- Automatic fail-over between 4G cellular and EWAN
- Four-port 10/100 Ethernet interfaces
- SOHO firewall security with DoS prevention and SPI
- 802.11n high-speed wireless connection up to 150Mbps data rate
- Supports Wi-Fi Protected Setup (WPS) and WPA/2-PSK
- TR-069 Central Remote Management



BEC 6300VNL VoIP 4G/LTE Router

- Supports frequency bands:
 - √ LTE: B2/B4/B5/B12/B13/B17/B25
 - √ LTE: B3/B7/B8/B20
- Peak 100Mbps/50Mbps download/upload speed
- Dual APN with port mapping
- Two detachable 4G MIMO antennas with SX antenna technology
- WAN failover: 4G and EWAN (Fibre/DSL/cable)
- Four-port 10/100/1000 Gigabit Ethernet interfaces
- 802.11n high-speed wireless connection up to 300Mbps
- Wi-Fi quickly for support-free WLAN setup
- SOHO firewall security with DoS prevention and SPI
- TR-069 Central Remote Management
- Two FXS VoIP voice ports with advanced call features
- DC redundant power connector interface to UPS



BEC 6300NL 4G/LTE Router

- Supports frequency bands:
 - √ LTE: B2/B4/B5/B12/B13/B17/B25
 - √ LTE: B3/B7/B8/B20
- Peak downlink/uplink rate: 100Mbps/50Mbps (depend upon carrier network support)
- Two detachable 4G MIMO antennas with SX antenna technology
- WAN failover: 4G and EWAN (Fibre/DSL/cable)
- Four-port 10/100/1000 Gigabit Ethernet interfaces
- 802.11n high-speed wireless connection up to 300Mbps
- Wi-Fi quickly for support-free WLAN setup
- SOHO firewall security with DoS prevention and SPI
- TR-069 Central Remote Management



BEC SX-7 Antenna Technology

- Optimize for 700Mhz ~ 2100Mhz
- Plug-n-Play auto gain detection and self implementation
- Delivers dramatically superior range and optimized network capacity
- Up to 40% increase in signal reception and efficiency
- Slash operational costs: eliminate the need for external antennas

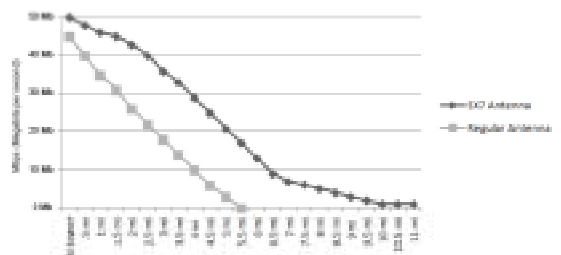

BEC 6800RUL 4G/LTE Outdoor Router

- Supports frequency bands:
 - √ LTE: B2/B4/B5/B12/B13/B17/B25/B38/B41
 - √ LTE: B3/B7/B8/B20
- Peak 100Mbps/50Mbps download/upload speed
- Routing or bridge mode
- Antenna options:
 - √ Two detachable MIMO N-type antenna (5 ~ 7 dbi)
 - √ Patch panel MIMO directional (9 ~ 13 dbi)
- One 10/100 Ethernet Interface auto MDI/MDIX with IEEE 802.3af compliant PoE P.D.
- Supports TR-069 Central Remote Management
- IP-67 grade enclosure
- Pole mount or wall mount
- Operating temperature -40°C to 60°C (-40°F to 140°F)



3G/4G LTE ADSL2+ Router Series



BiPAC 7800NX Triple-WAN Wireless-N 3G/4G LTE VPN ADSL2+/Fibre Broadband Router

- Triple-WAN ports - 3G/4G LTE, ADSL2+, Gigabit Ethernet WAN (EWAN) for broadband connectivity
- 1-port Gigabit WAN (LAN #4) and 4-port Gigabit switch
- Fibre (FTTC/FTTP/FTTH) ready with high WAN throughput
- USB port for print server, NAS, DLNA media server, and 3G/4G LTE USB modem
- SNR adjustments
- 16 IPsec VPN tunnels
- Multiple wireless SSIDs with wireless guest access and client isolation
- Supports IPTV applications*
- Supports port-based and tag-based Virtual LAN (VLAN)



BiPAC 7800NXL Triple-WAN Wireless-N 3G/4G LTE ADSL2+/ Fibre Broadband Router

- Triple-WAN ports - 3G/4G LTE, ADSL2+, Gigabit Ethernet WAN (EWAN) for broadband connectivity
- 1-port Gigabit WAN (LAN #4) and 4-port Gigabit switch
- Fibre (FTTC/FTTP/FTTH) ready with high WAN throughput
- USB port for print server, NAS, DLNA media server, and 3G/4G LTE USB modem
- SNR adjustments
- Multiple wireless SSIDs with wireless guest access and client isolation
- Supports IPTV applications*
- Supports port-based and tag-based Virtual LAN (VLAN)



BiPAC 7800DX Triple-WAN Dual-Band Wireless-N 600Mbps 3G/4G LTE ADSL2+/Fibre VPN Broadband Router

- Triple-WAN ports - 3G/4G LTE, ADSL2+, Gigabit Ethernet WAN (EWAN) for broadband connectivity
- Simultaneous dual-band Wireless-N 600Mbps (2.4GHz and 5GHz)
- 1-port Gigabit WAN (LAN #4) and 4-port Gigabit switch
- Fibre (FTTC/FTTP/FTTH) ready
- USB 2.0 port for print server, NAS, DLNA media server, and 3G/4G LTE USB modem
- SNR adjustments to achieve highest sync speeds
- 16 IPsec VPN tunnels
- Multiple wireless SSIDs
- Supports IPTV applications*
- Supports port-based and tag-based Virtual LAN (VLAN)



BiPAC 7800DXL Triple-WAN Dual-Band Wireless-N 600Mbps 3G/4G LTE ADSL2+/Fibre Broadband Router

- Triple-WAN ports - 3G/4G LTE, ADSL2+, Gigabit Ethernet WAN (EWAN) for broadband connectivity
- Simultaneous dual-band Wireless-N 600Mbps (2.4GHz and 5GHz)
- 1-port Gigabit WAN (LAN #4) and 4-port Gigabit switch
- Fibre (FTTC/FTTP/FTTH) ready
- USB 2.0 port for print server, NAS, DLNA media server, and 3G/4G LTE USB modem
- SNR adjustments to achieve highest sync speeds
- Multiple wireless SSIDs
- Supports IPTV applications*
- Supports port-based and tag-based Virtual LAN (VLAN)



BiPAC 7600NX Triple-WAN Wireless-N 3G/4G LTE VPN ADSL2+/Fibre Broadband Router

- Triple-WAN ports - 3G/4G LTE, ADSL2+, Gigabit Ethernet WAN (EWAN) for broadband connectivity
- 1-port Gigabit WAN and 4-port Gigabit switch
- Supports 300Mbps 802.11n wireless access point with WPA-PSK/WPA2-PSK
- Fibre (FTTC/FTTP/FTTH) ready with high WAN throughput
- USB port for storage (SAMBA server and FTP server) and 3G/4G LTE USB modem
- SNR adjustments
- 8 IPsec VPN tunnels
- Supports IPTV applications*



BiPAC 7600NXL Triple-WAN Wireless-N 3G/4G LTE ADSL2+/Fibre Broadband Router

- Triple-WAN ports - 3G/4G LTE, ADSL2+, Gigabit Ethernet WAN (EWAN) for broadband connectivity
- 1-port Gigabit WAN and 4-port Gigabit switch
- Supports 300Mbps 802.11n wireless access point with WPA-PSK/WPA2-PSK
- Fibre (FTTC/FTTP/FTTH) ready with high WAN throughput
- USB port for storage (SAMBA server and FTP server) and 3G/4G LTE USB modem
- SNR adjustments
- Supports IPTV applications*



BiPAC 7600X Triple-WAN 3G/4G LTE VPN ADSL2+/Fibre Broadband Router

- Triple-WAN ports - 3G/4G LTE, ADSL2+, Gigabit Ethernet WAN (EWAN) for broadband connectivity
- 1-port Gigabit WAN and 4-port Gigabit switch
- Fibre (FTTC/FTTP/FTTH) ready with high WAN throughput
- USB port for storage (SAMBA server and FTP server) and 3G/4G LTE USB modem
- SNR adjustments
- 8 IPsec VPN tunnels
- Supports IPTV applications*



BiPAC 7800X 3G/4G LTE VPN ADSL2+/Fibre VPN Broadband Router

- Triple-WAN ports for 3G/4G LTE, ADSL2+, Gigabit Ethernet WAN (EWAN) for broadband connectivity
- Gigabit WAN and LAN
- Fibre (FTTC/FTTP/FTTH) ready with high WAN throughput
- 16 IPsec VPN tunnels
- IPsec VPN client and server with powerful hardware encryption
- IPv6 ready (IPv4/IPv6 dual stacks)
- USB port for print server, NAS, DLNA media server, and 3G/4G LTE USB modem
- SNR adjustments to achieve highest sync speeds
- Monitoring of individual LAN ports
- QoS for traffic prioritization and bandwidth management
- Broadcom chipset for better stability
- Supports IPTV applications*
- Supports port-based Virtual LAN (VLAN)

* IPTV application may require subscribing to IPTV services from a Telco/ISP.

3G/4G LTE Broadband Router Series



BiPAC 6300NX Fibre/4G LTE/Cable Gigabit Wireless-N VPN Broadband Router

- Dual-WAN ports - Gigabit Ethernet WAN (E-WAN) and 3G/4G LTE for broadband connectivity
- Auto failover feature to ensure an always-on connectivity
- 802.11n wireless AP with high-speed wireless connection up to 300Mbps data rate
- Supports WPS and WPA-PSK/WPA2-PSK
- Gigabit WAN and LAN
- Fibre (FTTC/FTTP/FTTH) ready with high WAN throughput
- Embedded IPSec, PPTP and L2TP VPN endpoint/server with powerful encryption
- 24 VPN tunnels
- 4-port Gigabit Ethernet switches
- IPv6 ready
- Two USB ports for NAS and 3G/4G LTE USB modem
- Load balancing to maximize bandwidth of outbound traffic
- QoS for traffic prioritization and bandwidth management
- Multiple wireless SSIDs with wireless guest access and client isolation
- Supports IPTV applications*

*IPTV application may require subscribing to IPTV services from a Telco/ISP.



BiPAC 6300NXL Fibre/4G LTE/Cable Gigabit Wireless-N Broadband Router

- Dual-WAN ports - Gigabit Ethernet WAN (E-WAN) and 3G/4G LTE for broadband connectivity
- Auto failover feature to ensure an always-on connectivity
- 802.11n wireless AP with high-speed wireless connection up to 300Mbps data rate
- Supports WPS and WPA-PSK/WPA2-PSK
- Gigabit WAN and LAN
- Fibre (FTTC/FTTP/FTTH) ready with high WAN throughput
- 4-port Gigabit Ethernet switches
- IPv6 ready
- Two USB ports for NAS and 3G/4G LTE USB modem
- Load balancing to maximize bandwidth of outbound traffic
- QoS for traffic prioritization and bandwidth management
- Multiple wireless SSIDs with wireless guest access and client isolation
- Supports IPTV applications*

*IPTV application may require subscribing to IPTV services from a Telco/ISP.

3G/4G LTE Embedded ADSL2+ Router Series



BiPAC 7800GZ 3G/HSPA Embedded ADSL2+ Wireless VPN Firewall Router

- Dual-WAN approach - ADSL2+, 3G or Ethernet WAN for broadband connectivity
- 3G embedded with a built-in SIM card slot
- Integrated 4-port Ethernet switch
- 4 IPSec VPN tunnels supported
- Supports 802.11g wireless access point with WPA-PSK/WPA2-PSK
- WPS (Wi-Fi Protected Setup) for easy setup
- Quality of Service control
- SOHO firewall security with DoS prevention and packet filtering
- Supports IPTV applications*

*IPTV application may require subscribing to IPTV services from a Telco/ISP.



BiPAC 7820NZ 3G/4G LTE Embedded with Dual-SIM Slots ADSL2+ Wireless-N VPN Firewall Router

- IPv6 ready (IPv4/IPv6 dual stacks)
- Triple-WAN approach - ADSL2+, 3G/4G LTE or Ethernet WAN for broadband connectivity
- 3G/4G LTE embedded with dual-SIM slots for backup (One SIM is active, and the other SIM is backup.)
- High-speed Internet access via ADSL2/2+; backward compatible with ADSL
- Ethernet port #4 can be configured as a WAN interface for broadband connectivity
- Auto failover feature to ensure an always-on connection
- 16 IPSec VPN tunnels supported
- Secure VPN with powerful DES/3DES/AES
- Wireless speed of up to 300Mbps
- 802.11n Wireless Access Point with Wi-Fi Protected Setup (WPS), Wi-Fi Protected Access (WPA-PSK/WPA2-PSK) and Wired Equivalent Privacy (WEP)
- Quality of Service control for traffic prioritization and bandwidth management
- SOHO firewall security with DoS prevention and packet filtering
- Supports IPTV applications*
- Supports M2M monitoring and control applications

*IPTV application may require subscribing to IPTV services from a Telco/ISP.

Applications of Embedded Router

Billion BiPAC 7820NZ's uniquely embedded dual-SIM card slots enable users to enjoy constant and seamless Internet experience by simply plugging 3G/4G LTE SIM cards into its built-in SIM slots without the needs of additional 3G/4G LTE USB modems. One SIM card is active and the other is backup. It is perfectly suitable for machine-to-machine (M2M) applications in industries ranging from automotive, agriculture, construction, healthcare, logistics, retail services, public safety, and transportation.

Dual-WAN Connection

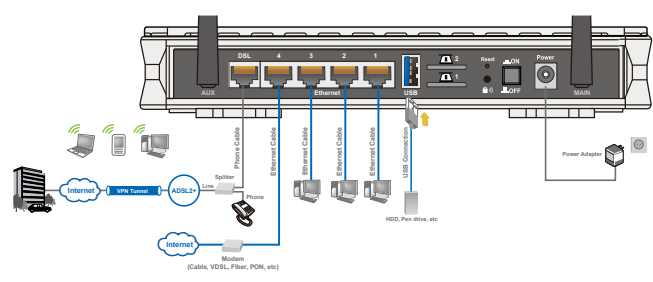

▲ ADSL fail-over to EWAN

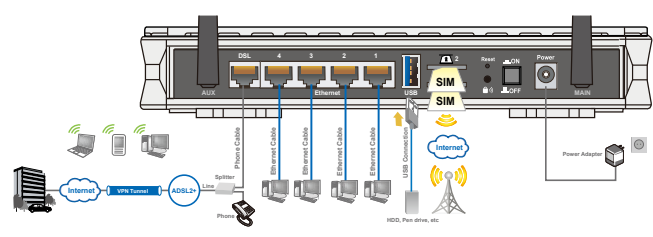

▲ ADSL fail-over to 3G/4G LTE

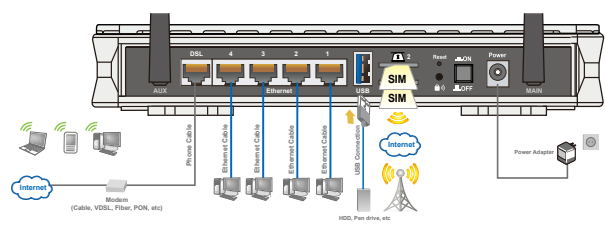

▲ Broadband (EWAN) fail-over to 3G/4G LTE

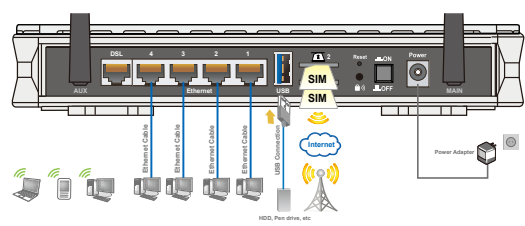

▲ 3G/4G LTE fail-over to the 3G/4G LTE

Complete Active Ethernet FTTH Last-Mile Access Solutions

Active Ethernet FTTH Solutions Last-Mile Access Solutions for Telco/ISP

Billion provides fibre switches and fibre router series products for Telco/ISP to deploy Giga wired-speed Active Ethernet FTTH last-mile access applications for residential and commercial areas.

Unique Features

1. A Giga wired-speed connection from CO site to home user
2. Establishes secure VPN connection from branch offices to headquarters
3. Easy deployment with PoE-PD feature

AE FTTH Solution for Home Users

A Complete AE (Active Ethernet) FTTH Solution for ISP/Telco to Provide Giga Wired-Speed FTTH Applications to Home Users

- Billion's Metro/Fiber Switch Series allows ISP/Telco to provide a reliable and high-performance infrastructure for home networks.
- Through its Giga fibre connection ports, end users can connect with Billion Giga fibre router - BiPAC 9800VNX, enjoying more cost-effective, faster and safer Giga wired-speed FTTH applications.

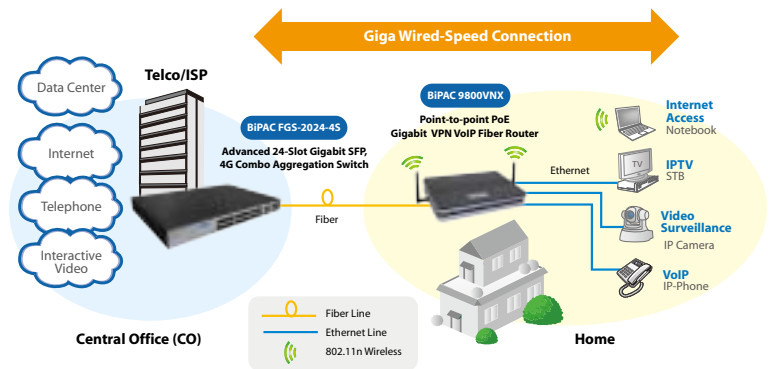

▲ A Giga Wired-Speed Connection from CO Site to Home User

Applications for SOHO/Small Office

Establishes Secure VPN Connection from Branch Offices to Headquarters

The BiPAC 9800VNX-PD supports comprehensive and robust IPsec VPN (Virtual Private Network) protocols for business users to establish, from branch offices to headquarters, private encrypted tunnels over the public Internet to secure data transmission.

Easy Deployment with PoE-PD Feature

The BiPAC 9800VNX-PD can also be deployed anywhere in the office by its POE-PD function. It can be powered by BiPAC GS-2008-2S SMB PoE+ Switch. This is perfect for SOHO and small offices to have a reliable, powering and networking infrastructure for their business network.

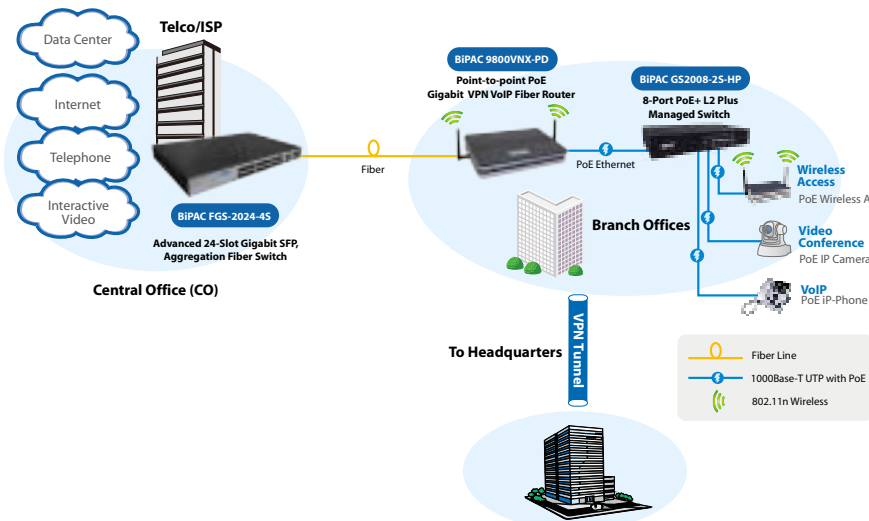

Point-to-Point Fibre Router Series



BiPAC 9800VNX-PD

Wireless-N 3G/4G LTE VoIP (VPN) PoE-powered Fibre Router

- WAN interface supports up to 1000 Mbps downstream and upstream wire-speed rates
- SFP interface supports 100Base or 1000Base fibre connectivity
- Extra RJ-45 Ethernet WAN port for connecting to ADSL/VDSL/Cable/Fibre modem device
- USB ports for NAS and 3G/4G LTE USB modem
- Auto failover feature to ensure an always-on connectivity
- 802.11n wireless AP with high-speed wireless connection up to 300Mbps data rate with WPS and WPA-PSK/WPA2-PSK
- Multiple wireless SSIDs 4-port Gigabit LAN switch
- Voice over IP compliant with SIP standards
- Two FXS ports for connecting to regular telephones
- QoS for traffic prioritization and bandwidth management
- Supports IPTV applications*
- PoE (Power over Ethernet) 802.3at PD (Powered Device) function supported to provide a green Fibre VPN gateway
- The integrated IPSec VPN function allows you to encrypt VPN tunnels
- Related models: BiPAC 9800NX-PD, BiPAC 9800VNX-PD and BiPAC 9800VNXL

*IPTV application may require subscribing to IPTV services from a Telco/ISP.

Switch Series



BiPAC FGS-2024-4S

Advanced 24-Slot Gigabit SFP Aggregation Fibre Switch

- Web-based/SNMP management
- Port configuration, status, statistics
- LACP supported
- SNMP v1/v2c and RMON
- MAC filtering
- Static link trunking
- DHCP snooping
- Network storm control
- Port isolation
- ACL L2/L3/L4
- 802.1x support
- Traffic management and QoS



BiPAC GS2008-2S-HP

8-Port 10/100/1000Base-T + 2 (100/1G)SFP PoE+ L2 Plus Managed Switch

- L2+ features provide better manageability, security, QoS, and performance
- Dual speed SFPs for FE or GbE fibre uplink
- IPv6 and s-Flow supports
- Easy-Port-Configuration for ease of setup in the IP phone, IP camera or wireless environment
- Supports 802.3at high power PoE plus standard



BiPAC GS2024-6S-HP

24-Port 10/100/1000Base-T + (100/1G)SFP Combo PoE+ L2 Plus Managed Switch

- L2+ features provide better manageability, security, QoS, and performance
- Dual speed SFPs for FE or GbE fibre uplink
- IPv6 and s-Flow supports
- Easy-Port-Configuration for ease of setup in the IP Phone, IP camera or wireless environment
- Supports 802.3at high power PoE plus standard



BiPAC GS2048-4S-HP

44-Port 10/100/1000Base-T + 4 TP/(100/1G)SFP Combo PoE+ L2 Plus Managed Switch

- L2+ features provide better manageability, security, QoS, and performance
- Dual speed SFPs for FE or GbE fibre uplink
- 802.3az Energy Efficient Ethernet standard
- IPv6 and s-Flow supports
- Support static route function
- Easy-Port-Configuration for ease of setup in the IP phone, IP camera or wireless environment
- Supports 802.3at high power PoE plus standard



BiPAC SGS2003-HP

3-port 10/100/1000TX Industrial Solar-Powered PoE+ Managed Ethernet Switch

- 2-port 10/100/1000Base-TX (PSE , 802.3af/at)
- 1-port 10/100/1000Base-TX (PD, 802.3af/at)
- For harsh & extreme industrial type applications
- Wide operating temperature from -20°C ~ 60°C
- Input power: PV DC 18 ~ 55V, PD DC 48V
- Web-based/SNMP Management
- Security: Port isolation, ACL L2/L3/L4, 802.1x
- Smart power management system
- Co-working with 300 watts solar PV kit and LFP battery
- Multi-function charger source can be solar panel and PoE PD
- Long distance IP surveillance solution through fibre
- Over-current and over-temperature protection
- Reverse polarity protection (for battery and PV Panel)
- Supply device require DC power (12V 2A)

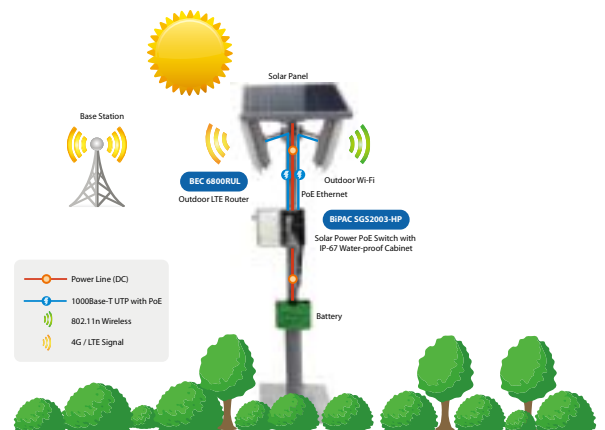

VDSL2 Series



BiPAC 8300N(X)L R3 Wireless-N VDSL2/ADSL2+ Firewall Router

- Very High-speed Internet access via VDSL2; auto fallback to ADSL2+
- VDSL2 profiles: 8a/b/c/d, 12a/b, 17a, 30a
- 4-port 10/100Mbps Fast Ethernet switch
- Supports 802.11n Wi-Fi access point with WPA-PSK/WPA2-PSK
- WPS (Wi-Fi Protected Setup) for easy setup
- Wireless speed up to 300Mbps and 3 times the coverage of standard 802.11g
- Quality of Service control for traffic prioritization
- SOHO firewall security with DoS prevention and packet filtering
- Universal Plug and Play (UPnP) compliance
- Dynamic Domain Name System (DDNS)
- Ease of use with Quick Installation Wizard
- USB 2.0 supports storage/NAS (BiPAC 8300NXL R3)
- Supports IPv6*
- Supports TR-069 (CWMP)*

* Only upon request for Telco/ISP tender projects.



BiPAC 8800NL Wireless-N VDSL2(Fibre)/ADSL2+ Firewall Router

- Supports VDSL2 and ADSL2+
- 3-port 10/100Mbps switch and 1-port Gigabit switch
- Ethernet port #4 can be configured as a WAN interface for broadband connectivity
- USB port for FTP, NAS and DLNA media server
- SNR adjustments to achieve highest sync speeds
- Monitoring of individual LAN ports
- QoS for traffic prioritization and bandwidth management
- Compliant with IEEE 802.11b/g/n standards
- WPS (Wi-Fi Protected Setup) for easy setup
- Wireless security with WPA-PSK/WPA2-PSK
- Supports WDS repeater function
- SOHO firewall security
- IPv6 ready
- Supports IPTV application*
- Ease of use with quick installation wizard (EZSO)
- Broadcom chipset for better stability

* IPTV application may require subscribing to IPTV services from a Telco/ISP.



BiPAC 8400N(X)L Wireless-N VDSL2/ADSL2+ Firewall Router

- Very High-speed Internet access via VDSL2; Auto fallback to ADSL2+
- VDSL2 profiles: 8a/b/c/d, 12a/b, 17a, 30a
- 4-port 10/100Mbps Fast Ethernet switch
- Supports 802.11n Wi-Fi access point with WPA-PSK/WPA2-PSK
- WPS (Wi-Fi Protected Setup) for easy setup
- Wireless speed up to 300Mbps and 3 times the coverage of standard 802.11g
- Quality of Service control for traffic prioritization
- SOHO firewall security with DoS prevention and packet filtering
- Universal Plug and Play (UPnP) compliance
- Dynamic Domain Name System (DDNS)
- Ease of use with Quick Installation Wizard
- USB 2.0 supports storage/NAS (BiPAC 8400NXL only)
- Supports IPv6*
- Supports TR-069 (CWMP)*

* Only upon request for Telco/ISP tender projects.



BiPAC 8200M VDSL2 Modem

- Compliant with ITU-T G.993.2 VDSL2 standard
- VDSL2 profiles: 8a/b/c/d, 12a/b, 17a, 30a
- Supports back-to-back applications
- Upstream/downstream connection rates up to 100Mbps
- OLR (On Line Reconfiguration) supported
- Ethernet packets over VDSL2
- Integrated 4-port Ethernet switch
- DIP settings for Remote Terminal (RT)/Central Office Terminal (COT)



BiPAC 8800AXL Wireless-AC 1300Mbps Wireless-N Triple-WAN ADSL2+/3G/4G LTE Firewall Router

- Triple-WAN ports for ADSL2+ fallback and 3G/4G LTE USB modem connectivity
- 4-port Gigabit Switch
- 1-port Gigabit Ethernet WAN (EWAN) port for Broadband connectivity or can be configured as LAN#5
- 2 USB ports for print server, NAS, DLNA, and 3G/4G LTE USB modem
- Compliant with IEEE 802.11b/g/n/ac standards
- Ultimate Wireless speed 300+1300Mbps
- WPS (Wi-Fi Protected Setup) for easy setup
- Wireless security with WPA-PSK/WPA2-PSK
- Supports WDS repeater function
- SNR adjustments to achieve highest sync speeds
- Monitoring of individual LAN/WAN traffic
- QoS for traffic prioritization and bandwidth management
- SMS alert and mail alert for default WAN IP changed
- SOHO firewall security
- Auto failover and fallback
- Supports IPTV application*
- Ease of use with quick installation wizard (EZSO)
- Broadcom chipset for better stability

* IPTV application may require subscribing to IPTV services from a Telco/ISP.



BiPAC 8920AL* Bonded VDSL2 with Triple-WAN, Wireless 1300Mbps, 3G/4G LTE and VDSL2/ADSL2+ Firewall Router

- Compliant with all ADSL2+/VDSL2 single and bonding standards
- Triple-WAN ports for 3G/4G LTE, VDSL2/ADSL2+ fallback, Gigabit Ethernet WAN (EWAN) for broadband connectivity
- Simultaneous dual-band Wireless 1300Mbps (2.4GHz) and 300Mbps (5GHz)
- Gigabit WAN and LAN
- IPv6 ready (IPv4/IPv6 dual stacks)
- Fibre (FTTC/FTTP/FTTH) ready with high WAN throughput
- USB port for print server, NAS, DLNA media server, and 3G/4G LTE USB modem
- SNR adjustments to achieve highest sync speeds
- Monitoring of individual LAN ports
- QoS for traffic prioritization and bandwidth management
- Compliant with IEEE 802.11a/b/g/n and ac standards
- WPS (Wi-Fi Protected Setup) for easy setup
- Wireless security with WPA-PSK/WPA2-PSK
- Supports WDS repeater function
- Multiple wireless SSIDs with wireless guest access and client isolation
- Supports virtual LAN (port-based VLAN)
- SOHO firewall security
- Auto failover and fallback
- Supports IPTV application*
- Ease of use with quick installation wizard (EZSO)
- Broadcom chipset for better stability

* Please contact us for more details. IPTV application may require subscribing to IPTV services from a Telco/ISP.



VoIP ADSL2+ Router Series



BiPAC 7800VDPX Triple-WAN Dual-Band Wireless-N 600Mbps 3G/4G LTE VoIP ADSL2+/ Fibre Broadband Router

- Triple-WAN ports - 3G/4G LTE, ADSL2+, Gigabit Ethernet WAN (EWAN) for broadband connectivity
- Dual-band Wireless-N 600Mbps (2.4GHz and 5GHz)
- VoIP/PSTN with failover to PSTN on power or ADSL failure
- Gigabit WAN and LAN
- Fibre (FTTC/FTTP/FTTH) ready
- USB port for print server, NAS, DLNA media server, and 3G/4G LTE USB modem
- Broadcom chipset for better stability
- SIP gateway - least cost routing for VoIP calls
- Supports telephony features: call waiting, caller ID, three-way conference, and answering machine function, etc.
- Multiple wireless SSIDs with wireless guest access and client isolation



BiPAC 7800VDOX Triple-WAN Dual-Band Wireless-N 600Mbps 3G/4G LTE VoIP VPN ADSL2+ /Fibre Broadband Router

- Triple-WAN ports - 3G/4G LTE, ADSL2+, Gigabit Ethernet WAN (EWAN) for broadband connectivity
- Dual-band Wireless-N 600Mbps (2.4GHz and 5GHz)
- VoIP/PSTN with failover to PSTN on power or ADSL failure
- Gigabit WAN and LAN
- Fibre (FTTC/FTTP/FTTH) ready
- 16 IPsec VPN tunnels
- USB port for print server, NAS, DLNA media server, and 3G/4G LTE USB modem
- Broadcom chipset for better stability
- SIP gateway - least cost routing for VoIP calls
- Supports telephony features: call waiting, caller ID, three-way conference, and answering machine function, etc.
- Multiple wireless SSIDs with wireless guest access and client isolation



BiPAC 8900TAOX* Wireless-AC 1300Mbps 3G/4G LTE VDSL2/ ADSL2+ VPN with VoIP DECT Embedded Router

- Triple-WAN ports for 3G/4G LTE, ADSL2+, Gigabit Ethernet WAN (EWAN) for broadband connectivity
- Simultaneous dual-band Wireless 1300Mbps (2.4GHz) and 300Mbps (5GHz)
- VoIP/PSTN with failover to PSTN on power or ADSL failure
- Gigabit WAN and LAN
- Fibre (FTTC/FTTP/FTTH) ready with high WAN throughput
- IPv6 ready (IPv4/IPv6 dual stacks)
- USB port for print server, NAS, DLNA media server, and 3G/4G LTE USB modem
- SNR adjustments to achieve highest sync speeds
- Monitoring of individual LAN ports
- QoS for traffic prioritization and bandwidth management
- Broadcom chipset for better stability
- SIP gateway - least cost routing for VoIP calls
- DECT base station is embedded to support cordless DECT handset
- Supports telephony features: call waiting, caller ID, three-way conference, and answering machine function, etc.
- Multiple wireless SSIDs with wireless guest access and client isolation
- Ideal for SOHO and office users

To be available



* Please contact us for more details.

SHDSL Series



BiPAC 8501 R3 5.7Mbps SHDSL.bis Firewall Bridge/Router

- Symmetric data transfer rate of up to 5.7Mbps
- High-speed internet access with SHDSL.bis, backward compatible with SHDSL
- Back-to-back connectivity
- SOHO firewall security with DoS prevention and SPI
- Access control with URL blocking and packet filtering
- DiffServ Quality of Service
- Dynamic Domain Name System (DDNS)
- Integrated 4-port Ethernet switch



BiPAC 8521 R3 11.4Mbps SHDSL.bis Firewall Bridge/Router

- Supports symmetric data transfer rate of up to 11.4Mbps
- High-speed internet access with SHDSL.bis, backward compatible with SHDSL
- Back-to-back connectivity
- SOHO firewall security with DoS prevention and SPI
- Access control with URL blocking and packet filtering
- Quality of Service control
- Dynamic Domain Name System (DDNS)
- Integrated 4-port Ethernet switch

Wireless Router Series



BiPAC 7800N 802.11n ADSL2+/Broadband Firewall Router with Gigabit Ethernet Switch

- Dual-WAN approach - ADSL2+ or Ethernet WAN for broadband connectivity
- High-speed Internet access via ADSL2/2+; backwards compatible with ADSL
- 4-port Gigabit switch
- Wireless Access Point speed up to 300Mbps with Wi-Fi Protected Access (WPA-PSK/WPA2-PSK), Wi-Fi Protected Setup (WPS), and Wired Equivalent Privacy (WEP)
- Quality of Service control
- SOHO firewall security with DoS prevention and packet filtering
- Universal Plug and Play (UPnP)
- Dynamic Domain Name System (DDNS)
- Supports IPTV applications*
- Easy Sign-On (EZSO)

* IPTV application may require subscribing to IPTV services from a Telco/ISP.



BiPAC 7800NL All-in-One ADSL2+ Router with Wireless-N Technology

- IPv6 ready (IPv4/IPv6 dual stack)
- 4-port 10/100Mbps Ethernet switch integrated
- High-speed Internet access via ADSL2/2+; backward compatible with ADSL
- 802.11n Wireless Access Point with Wi-Fi Protected Setup (WPS), Wi-Fi Protected Access (WPA-PSK/WPA2-PSK) and Wired Equivalent Privacy (WEP)
- Wireless speed up to 300Mbps
- Quality of Service control for traffic prioritization and bandwidth management
- SOHO firewall security with DoS prevention and packet filtering
- Universal Plug and Play (UPnP)
- Dynamic Domain Name System (DDNS)
- Available syslog
- Ease of use with quick installation wizard and auto-scan ADSL settings
- Featuring VLAN to support IPTV applications*
- Easy Sign-On (EZSO)

* IPTV application may require subscribing to IPTV services from a Telco/ISP.



BiPAC 7700N R2 All-in-One ADSL2+ Router with Wireless-N Technology

- Supports multiple LAN segments for network applications
- 4-port 10/100Mbps Ethernet switch integrated
- High-speed Internet access via ADSL2/2+; backward compatible with ADSL
- 802.11n Wireless Access Point with Wi-Fi Protected Access (WPA-PSK/WPA2-PSK), Wi-Fi Protected Setup (WPS), and Wired Equivalent Privacy (WEP)
- Wireless speed up to 300Mbps
- Quality of Service control for traffic prioritization management
- SOHO firewall security with DoS prevention and packet filtering
- Universal Plug and Play (UPnP)
- Dynamic Domain Name System (DDNS)
- Available syslog
- Supports IPTV applications*

* IPTV application may require subscribing to IPTV services from a Telco/ISP.



BiPAC 7300N RE Wireless-N 300Mbps ADSL2+ Router

- Dual-WAN approach – ADSL2+ or Ethernet WAN
- High speed Internet access with ADSL2/2+; also compatible with ADSL
- Wireless Access Point speed up to 300Mbps with Wi-Fi Protected Access (WPA-PSK/WPA2-PSK), Wi-Fi Protected Setup (WPS), and Wired Equivalent Privacy (WEP)
- Integrated with 4-port 10/100M Ethernet switch
- SOHO firewall security with DoS prevention and SPI
- Universal Plug and Play (UPnP) compliant
- Virtual Private Network (VPN) pass-through
- Quality of Service control
- Dynamic Domain Name System (DDNS)
- Easy Sign-On (EZSO)
- Supports IPTV applications*

* IPTV application may require subscribing to IPTV services from a Telco/ISP.



BiPAC 7300W R2 Wireless-N 150Mbps ADSL2+ Router

- IPv6 ready (IPv4/IPv6 dual stack)
- Dual-Stack Lite and 6RD (IPv6 Rapid Deployment)¹
- Deployment¹
- Wireless-N AP with Wi-Fi Protected Access (WPA-PSK/WPA2-PSK) and Wired Equivalent Privacy (WEP)
- Multiple wireless SSIDs with wireless guest access and client isolation
- High speed Internet access with ADSL2/2+; backward compatible with ADSL
- 4-port Ethernet switches
- SOHO firewall security with DoS prevention and SPI
- Universal Plug and Play (UPnP)
- Supports Virtual Private Network (VPN) pass-through
- Quality of Service Control
- Dynamic Domain Name System (DDNS)
- Easy network management (Easy Sign On, Quick Start Wizard and Web GUI permission)
- Supports IPTV application²

¹. Only upon request for Telco/ISP tender projects.
². IPTV application may require subscribing to IPTV services from a Telco/ISP.



BiPAC 7300NX R3 Wireless-N ADSL2+ Firewall Router

- IPv6 ready (IPv4/IPv6 dual stack)
- Dual-Stack Lite and 6RD (IPv6 Rapid Deployment)¹
- Wireless-N AP with Wi-Fi Protected Access (WPA-PSK/WPA2-PSK) and Wired Equivalent Privacy (WEP)
- Multiple wireless SSIDs with wireless guest access and client isolation
- High speed Internet access with ADSL2/2+; backward compatible with ADSL
- 4-port Ethernet switches
- SOHO firewall security with DoS prevention and SPI
- Universal Plug and Play (UPnP)
- Supports Virtual Private Network (VPN) pass-through
- Quality of Service Control
- Dynamic Domain Name System (DDNS)
- USB 2.0 supports 3G/4G-LTE modem and storage/NAS
- Easy network management (Quick Start Wizard and Web GUI permission)
- Supports IPTV applications²

¹. Only upon request for Telco/ISP tender projects.
². IPTV application may require subscribing to IPTV services from a Telco/ISP.

Wireless Router Series



BiPAC 5400W R2 Wireless-N 150Mbps ADSL2+ Firewall Router

- Based on Wireless-N technology, and compliant with IEEE 802.11g, 802.11b standards
- High-speed wireless connection up to 150Mbps
- IPv6 ready
- Wireless-N AP with Wi-Fi Protected Access (WPA-PSK/WPA2-PSK) and Wired Equivalent Privacy (WEP)
- High speed Internet access with ADSL2/2+; backward compatible with ADSL
- 4-port Ethernet switch
- SOHO firewall security with DoS prevention and SPI
- Universal Plug and Play (UPnP)
- Supports Virtual Private Network (VPN) pass-through
- Quality of Service control
- Dynamic Domain Name System (DDNS)
- Easy network management
- Supports IPTV applications*

* IPTV application may require subscribing to IPTV services from a Telco/ISP.



BiPAC 5200W Wireless-N 150Mbps ADSL2+ Router

- Based on Wireless-N technology, and compliant with IEEE 802.11g, 802.11b standards
- High-speed wireless connection up to 150Mbps
- Wireless-N AP with Wi-Fi Protected Access (WPA-PSK /WPA2-PSK) and Wired Equivalent Privacy (WEP)
- High speed Internet access with ADSL2/2+; backward compatible with ADSL
- 4-port Ethernet switch
- SOHO firewall security with DoS prevention and SPI
- Universal Plug and Play (UPnP)
- Virtual Private Network (VPN) pass-through
- Quality of Service control
- Dynamic Domain Name System (DDNS)
- Easy network management



BiPAC 5400N R2 300Mbps Wireless-N ADSL2+ Firewall Router

- High speed Internet access with ADSL2/2+; backward compatible with ADSL
- Compatible with IEEE 802.11b/g/n standards
- Wireless speed up to 300Mbps
- Integrated 4-port Ethernet switch
- Supports IPv6
- WPS (Wi-Fi Protected Setup) for easy setup
- SOHO firewall security
- Supports VPN pass-through
- Quality of Service (QoS) control
- Web-based configuration
- Easy network management

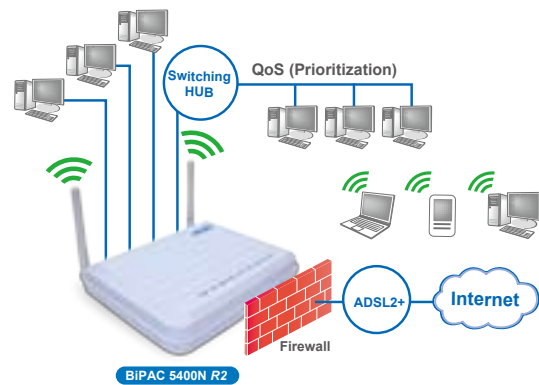

Wireless AP



BiPAC 3100SN Wireless-N Wall Plug Access Point

- Extended wireless coverage of up to 3 times the range of 802.11g products
- Wireless Access Point speed up to 300Mbps with Wi-Fi Protected Access (WPA-PSK/ WPA2-PSK), Wi-Fi Protected Setup (WPS), and Wired Equivalent Privacy (WEP)
- WPS (Wi-Fi Protected Setup) for easy setup
- WDS repeater & bridge function supported
- Auto channel select
- Wireless MAC access control prevents unauthorized access
- Supports triple-play applications such as IPTV, VoIP and high-speed Internet access
- 10/100Base Ethernet port

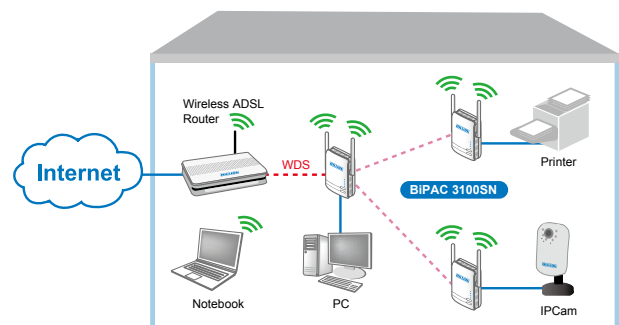

Wireless Adapter Series



BiPAC 3011N Wireless-N 300Mbps USB Adapter

- Compliant with draft 802.11n, 802.11g, and 802.11b network devices
- Internal two antennas with one TX and two RX
- Supports up to 300Mbps download and 150Mbps upload data rate
- Supports WEP, WPA, WPA2, and 802.1x for WLAN security
- WPS (Wi-Fi Protected Setup) for easy setup
- QoS enhancement for multimedia applications
- Comply with IEEE 802.11h for spectrum and transmit power management
- Supports auto-installation and diagnostic utilities

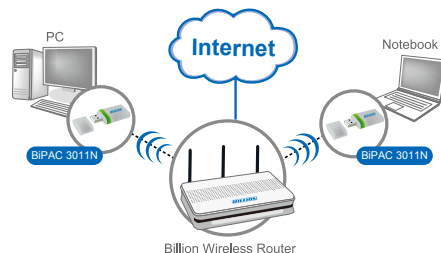

BiPAC 3010A Wireless-AC Dual-Band USB Adapter

- Compliant with IEEE 802.11a/b/g/n/ac standards
- High data transfer rate – 2.4GHz up to 300Mbps, 5GHz up to 867Mbps
- Further coverage, less dead spaces and higher throughput with MIMO technology
- Enables xDSL router, cable modem, STB, or multi-media devices, etc. to have 11ac Wi-Fi capability
- Supports IEEE 802.11e QoS enhancement (WMM)
- Supports Windows XP/Vista/7/8 and MAC OS 10.4 - 10.9
- Supports USB 3.0/2.0 type A interface
- Adjustable foldaway antenna for optimum wireless performance

2.4GHz (up to 300Mbps) Basic Internet Access



5GHz (up to 867Mbps) HD Video and On-line Gaming



ADSL2+ Modem/Router Series



BiPAC 5200 RC ADSL2+ Firewall Router

- High speed Internet access with ADSL2/2+; backward compatible with ADSL
- Integrated 4-port Ethernet switch
- SOHO firewall security with DoS prevention and packet filtering
- Universal Plug and Play (UPnP) compliant
- Dynamic Domain Name System (DDNS)
- Supports Virtual Private Network (VPN) pass-through
- Ideal for home and SOHO users



BiPAC 7800 ADSL2+/Broadband Firewall Router with Gigabit Ethernet Switch

- IPv6 ready
- Dual-WAN approach - ADSL2+ or Ethernet WAN for broadband connectivity
- 4-port Gigabit switch
- High-speed Internet access via ADSL2/2+; backward compatible with ADSL
- Auto fail-over feature to ensure an always-on connection
- Quality of Service control for traffic prioritization and bandwidth management
- SOHO firewall security with DoS prevention
- Ease of use with quick installation wizard and auto-scan ADSL settings
- Supports IPTV applications*

* IPTV application may require subscribing to IPTV services from a Telco/ISP.



BiPAC 7300 RA ADSL2+ Firewall Router

- High speed Internet access with ADSL2/2+; backward compatible with ADSL
- SOHO firewall security with DoS prevention and packet filtering
- Easy Sign-On (EZSO) and web-based configuration
- Quality of Service control
- Universal Plug and Play (UPnP) compliant
- Dynamic Domain Name System (DDNS)
- Supports VPN pass-through
- Ideal for home and SOHO users

Powerline Series



BiPAC 2075 Homplug AV 500M Wall Plug Gigabit Ethernet Adapter

- Provides 500Mbps data rate over existing in-home powerlines
- Gigabit Ethernet port
- IEEE1901 and HomePlug AV compliant
- European Union's Energy-using Products (EuP) Directive compliant
- Smart power saving technology for improved power efficiency
- Supports triple-play applications such as IPTV, VoIP and high-speed Internet access



BiPAC 2073N Wireless-N HomePlug AV 200 Wall Plug Ethernet Adapter

- Provides 200Mbps data rate over existing in-home power lines
- Wireless AP speed up to 300Mbps with WPA/WPA2
- WDS for wireless network expansion
- WPS (Wi-Fi Protected Setup) for easy setup
- Auto channel select
- Utilizes Quality of Service control
- Supports triple-play applications such as IPTV, VoIP and high-speed Internet access
- Supports 10/100 Base-T Ethernet
- HomePlug AV compliant



BiPAC 2073 R2 HomplugAV 200 Wall Plug Ethernet Adapter

- Provides 200Mbps data rate via electrical wiring
- Enable data transmission through existing home power grid
- Smart power saving technology for improved power efficiency
- Supports triple-play applications such as IPTV, VoIP and high-speed Internet access
- Supports 10/100 Base-T Ethernet
- HomePlug AV compliant



BiPAC 2074 R2 HomePlug AV 200 Wall Plug Ethernet Adapter with AC Pass-through Power Socket

- Provides 200Mbps data rate via electrical wiring
- Enable data transmission through existing home power grid
- Smart power saving technology for improved power efficiency
- Provides a noise-filtered power socket with AC Pass-through
- Supports triple-play applications such as IPTV, VoIP and high-speed Internet access
- Supports 10/100 Base-T Ethernet
- HomePlug AV compliant



BiPAC 2098 Powerline Gigabit Ethernet Adapter

- Interoperable with G.hn standard
- High-speed data transmission up to 1Gbps PHY rate
- State-of-the-art LDPC forward error correction
- Provides one AC pass-through power socket with noise-filtering function
- Build-in automatic relaying function for increased connection coverage
- AES 128 bits encryption algorithm using CCMP protocol
- Utilizes Quality of Service control
- Supports triple-play applications such as IPTV, VoIP and high-speed Internet access
- 1 x 10/100/1000 Base-T Ethernet port
- Ideal for SOHO, small office and residential users



BiPAC 2093 R2 Pocket-sized HD200 Powerline Wall Plug Ethernet Adapter

- Coexist with G.hn standard
- Enables high-speed data transfer rate up to 200Mbps via electrical wiring
- Smart Power Saving technology for improved power efficiency
- Smart Route delivers the best transmission path
- Smart Repeater for increased connection coverage
- Utilizes Quality of Service control
- Supports triple-play applications such as IPTV, VoIP and high-speed Internet access
- 1x 10/100 Base-T Ethernet port
- Slim and light weight design
- Ideal for residential users



BiPAC 2094 R2 HD200 Powerline Wall-Plug Adapter with Noise-Filtering Power Socket

- Co-exist with G.hn standard
- Enables high-speed data transfer rate up to 200Mbps via electrical wiring
- Includes one AC Pass-through power socket with noise-filtering function
- Smart Power Saving technology for improved power efficiency
- Smart Route delivers the best transmission path
- Smart Repeater for increased connection coverage
- Utilizes Quality of Service control
- Supports triple-play applications such as IPTV, VoIP and high-speed Internet access
- 1x 10/100 Base-T Ethernet port
- Slim and light weight design
- Ideal for residential users



BiPAC 2076 Homplug AV 500M Wall Plug Gigabit Ethernet Adapter with AC Pass-through Power Socket

- Provides 500Mbps data rate over existing in-home power lines
- Gigabit Ethernet port
- IEEE1901 and HomePlug AV compliant
- European Union's Energy-using Products (EuP) Directive compliant
- Smart power saving technology for improved power efficiency
- Supports triple-play applications such as IPTV, VoIP and high-speed Internet access
- Provides a noise-filtered power outlet with AC pass-through



www.billion.com
www.smartgrid.com.tw

Company Quick Facts

Capital	USD 31 Million
Employees	700+ (Taiwan, China, and USA)
Initial Public Offer	Taiex #3027 since Jan. 19, 2000
R&D Laboratories	5 Labs (Taiwan and China)
Production Capacity	400,000+ units per month
Certification	ISO 9001, ISO14001, IECQ QC080000, TL 9000

Billion Products and Solutions



Communication
Products



Smart Grid AMI
Series



Power & Energy
Management Products



Smart Home
Series



Smart Lighting
Solutions

Billion Electric Co., Ltd.

8F., No. 192, Sec. 2, Zhongxing Road,
Xindian Dist., New Taipei City,
Taiwan, R.O.C.
TEL : +886-2-2914-5665
FAX : +886-2-2918-2895
E-mail : marketing@billion.com

BEC Technologies Inc.

Central Region Headquarters
1500 Precision Drive, Suite 100
Plano, TX 75074
USA
TEL : +1-972-422-0877
FAX : +1-972-422-0886
E-mail : smartgrid@billion.com

Billion China

EG-Billion Electronics (Dongguan) Co., Ltd.
The Scientific & Technologic Industry Zone
Shijie Town, Dongguan City, Guangdong Province
China
TEL : +86-769-86633718
FAX : +86-769-86633739
E-mail : marketing@billion.com